

INSTALLATION APPLICATION

- IDEAL INSULATION FOR POST FRAME BUILDING APPLICATIONS
- QUICK AND EASY TO INSTALL, AND ADDS R-VALUE
- REDUCES HEAT LOSS AND HEAT GAIN ALL YEAR ROUND
- WILL BLOCK UP TO 96% OF RADIANT HEAT TRANSFER

INSTALLATION METHOD

1. Attach rFOIL™ insulation to the top purlin of the building wall and unroll product vertically (Keep the insulation tight as its unrolled).
2. Attach the product to purlins using staples.
3. Run subsequent rFOIL™ Insulation and butt it up to the previous installed layer
4. Seal all seams with rFOIL™ tape.
5. Affix wall panels as usual.

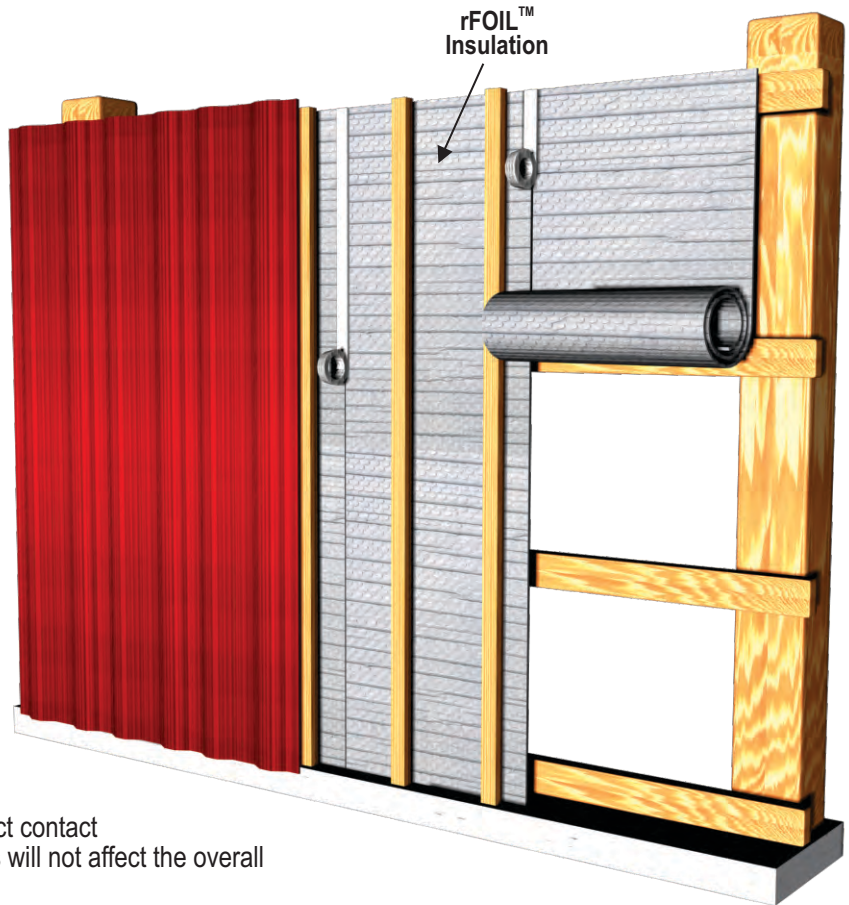

Builder's Notes:

- If a white interior finish is desired, rFOIL™ poly reflective insulation may be used. Install as per usual method, however with poly-white side facing interior.
- Use rFOIL™ white poly tape to seal all seams and butt joints.
- When rFOIL™ insulation comes in direct contact with ACQ lumber, it may discolour. This will not affect the overall insulation value of rFOIL™ insulation.

SUGGESTED PRODUCTS FOR THIS APPLICATION:

rFOIL™ INSULATION PRODUCT	2600, 2200, or 2500 Series (Available in Various Dimensions)
rFOIL™ TAPE	15013, 15012 (Reflective), 15853, 15852 (White Poly)

- a) Check local building codes for compliance before installation. This installation sheet is intended solely to illustrate the proper location and placement of rFOIL™ Reflective Insulation products in specific constructions applications. They are not intended to illustrate proper construction methods (which is ultimately the responsibility of the builder or contractor). The installation instructions are only recommendations relating to the location and placement of rFOIL™ Reflective Insulation products and rFOIL™ makes no claims that these construction systems are universally accurate.
- b) All warranties are void if rFOIL™ Reflective Insulation products are used in exterior applications, or in non-enclosed systems or buildings.
- c) Exercise caution when using rFOIL™ Reflective Insulation products near and around electrical wiring and devices.



279 Humberline Drive Etobicoke, ON M9W 5T6
 Call Toll Free: 1-800-837-8961 Local: 416-798-1340
 Fax: 416-798-1342 Email: sales@rfoil.com
Visit our Website: www.rfoil.com

