

- IDEAL INSULATION FOR METAL FRAME BUILDING APPLICATIONS
- QUICK AND EASY TO INSTALL, AND ADDS R-VALUE
- REDUCES HEAT LOSS AND HEAT GAIN ALL YEAR ROUND
- WILL BLOCK UP TO 96% OF RADIANT HEAT TRANSFER

INSTALLATION METHOD

1. Install 1"x 2" furring strips on the inside and perpendicular to the girts on 24" centers.
2. Unroll the rFOIL® Insulation parallel to the furring strips.
3. Staple the edges of the rFOIL® Insulation to the center of the furring strips. (Staple rFOIL® product at approximately 4" intervals down the center and into the furring strip)
4. Seal seams with rFOIL® reflective tape.

Builder's Notes:

- If a white interior finish is desired, rFOIL® poly reflective insulation may be used. Install as per usual method, however with poly-white side facing interior.
- Use rFOIL® white poly tape to seal all seams and butt joints.
- When rFOIL® insulation comes in direct contact with ACQ lumber, it may discolour. This will not affect the overall insulation value of rFOIL® insulation.

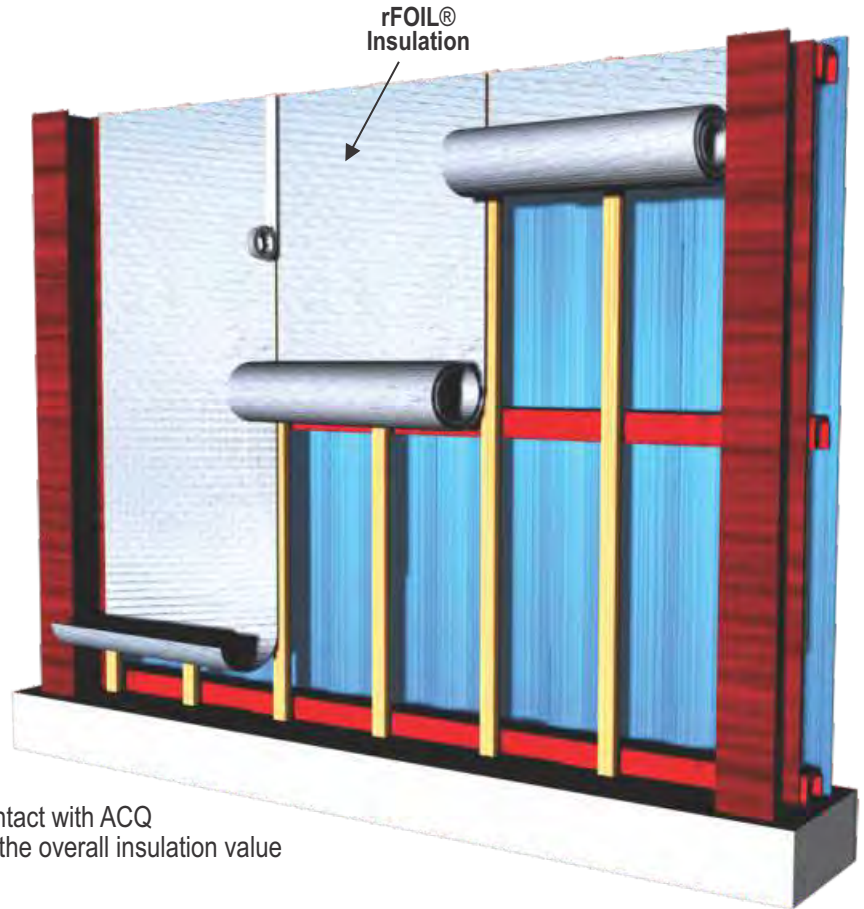

SUGGESTED PRODUCTS FOR THIS APPLICATION

rFOIL® INSULATION PRODUCT	2200, 2500 or 2600 Series (Available in Various Dimensions)
rFOIL® TAPES	for reflective side application 15072 or 15073 for poly side application 15852 or 15853

- a) Check local building codes for compliance before installation. This installation sheet is intended solely to illustrate the proper location and placement of rFOIL® Reflective Insulation products in specific constructions applications. They are not intended to illustrate proper construction methods (which is ultimately the responsibility of the builder or contractor). The installation instructions are only recommendations relating to the location and placement of rFOIL® Reflective Insulation products and rFOIL® makes no claims that these construction systems are universally accurate.
- b) All warranties are void if rFOIL® Reflective Insulation products are used in exterior applications, or in non-enclosed systems or buildings.
- c) Exercise caution when using rFOIL® Reflective Insulation products near and around electrical wiring and devices.

