

- CLASS 1 / CLASS A
- R10 VALUE BASED ON AIR SPACE
- 30% - 60% LESS COST THAN SHEET METAL & CORRUGATED ALUMINUM PANELS
- QUICK AND EASY TO INSTALL
- ENERGY EFFICIENT
- ENVIRONMENTALLY SAFE

### INSTALLATION METHOD

1. Staple rFOIL® insulation between the floor joists or to the side of the floor joists (open web trusses are acceptable).
2. Start at the end of the house and staple the rFOIL® insulation (print side out) to the sub-floor just behind the return air grate.
3. Staple the rFOIL® insulation to the bottom of the floor joist every 2". Other approved attachment methods include: sheet metal screws, roofing nails and steel staples
4. Seal all seams and butt joint using rFOIL® reflective tape.

NOTE: sheet metal has traditionally been used for both stud cavities and joist plenums. However, code does not specify types of materials allowed for panning.

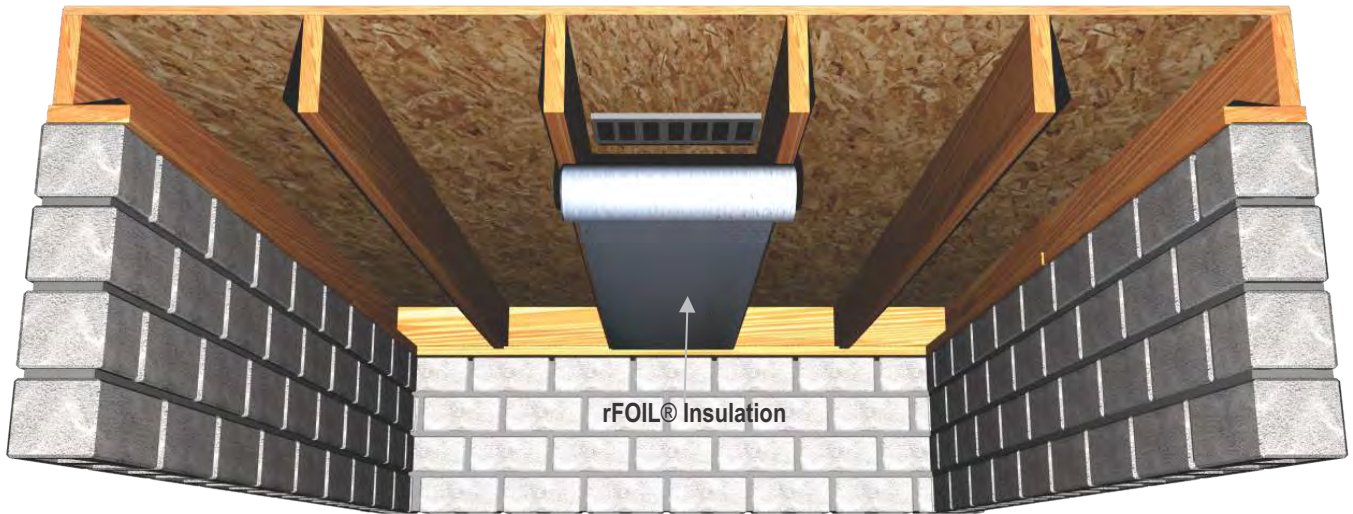

### SUGGESTED PRODUCTS FOR THIS APPLICATION

rFOIL® INSULATION PRODUCT	2210 Series (Available in Various Dimensions)
rFOIL® TAPES	15072 or 15073 (Metalized)

- a) Check local building codes for compliance before installation. This installation sheet is intended solely to illustrate the proper location and placement of rFOIL® Reflective Insulation products in specific constructions applications. They are not intended to illustrate proper construction methods (which is ultimately the responsibility of the builder or contractor). The installation instructions are only recommendations relating to the location and placement of rFOIL® Reflective Insulation products and rFOIL® makes no claims that these construction systems are universally accurate.
- b) All warranties are void if rFOIL® Reflective Insulation products are used in exterior applications, or in non-enclosed systems or buildings.
- c) Exercise caution when using rFOIL® Reflective Insulation products near and around electrical wiring and devices.

