

- HELPS PREVENT GROUND MOISTURE FROM CAUSING DRY-ROT
- REDUCES HEAT LOSS TO THE SURROUNDING ENVIRONMENT
- EXCELLENT VAPOR AND RADON BARRIER
- QUICK AND EASY TO INSTALL

INSTALLATION METHOD

1. Staple one end of rFOIL™ insulation to the Ring Box joist.
2. Run the insulation product along the underside of the joists, stapling the product every 4"-6".
3. Seal all seams with rFOIL™ reflective tape.

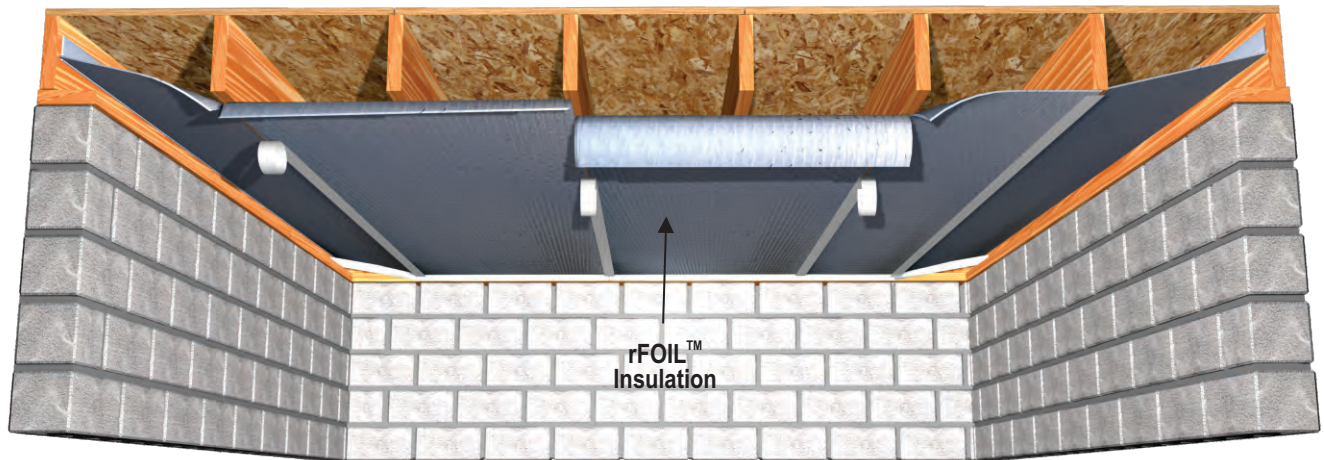

SUGGESTED PRODUCTS FOR THIS APPLICATION:

rFOIL™ INSULATION PRODUCT	2220 Series (Available in Various Dimensions)
rFOIL™ TAPE	15013 or 15012 (Reflective)

- a) Check local building codes for compliance before installation. This installation sheet is intended solely to illustrate the proper location and placement of rFOIL™ Reflective Insulation products in specific constructions applications. They are not intended to illustrate proper construction methods (which is ultimately the responsibility of the builder or contractor). The installation instructions are only recommendations relating to the location and placement of rFOIL™ Reflective Insulation products and rFOIL™ makes no claims that these construction systems are universally accurate.
- b) All warranties are void if rFOIL™ Reflective Insulation products are used in exterior applications, or in non-enclosed systems or buildings.
- c) Exercise caution when using rFOIL™ Reflective Insulation products near and around electrical wiring and devices.



279 Humberline Drive Etobicoke, ON M9W 5T6
 Call Toll Free: 1-800-837-8961 Local: 416-798-1340
 Fax: 416-798-1342 Email: sales@rfoil.com
Visit our Website: www.rfoil.com

