

- PERFORMANCE UNAFFECTED BY MOISTURE AND HUMIDITY
- QUICK AND EASY TO INSTALL, AND ADDS R-VALUE
- REDUCES HEAT LOSS AND HEAT GAIN ALL YEAR ROUND
- WILL BLOCK UP TO 96% OF RADIANT HEAT TRANSFER

INSTALLATION METHOD

1. Install unfaced mass insulation between rafters; be sure to leave at least 2" of ventilation space between the roof and the top of the insulation.
2. Unroll and staple rFOIL™ insulation to the underside of the rafters.
3. Seal all seams and butt joints with rFOIL™ tape to ensure a continuous insulation and vapor barrier.
4. Install wood strapping over insulation at 16" intervals - perpendicular to the rafters.
5. Install drywall to the furring strips - creating a reflective airspace between insulation and drywall.

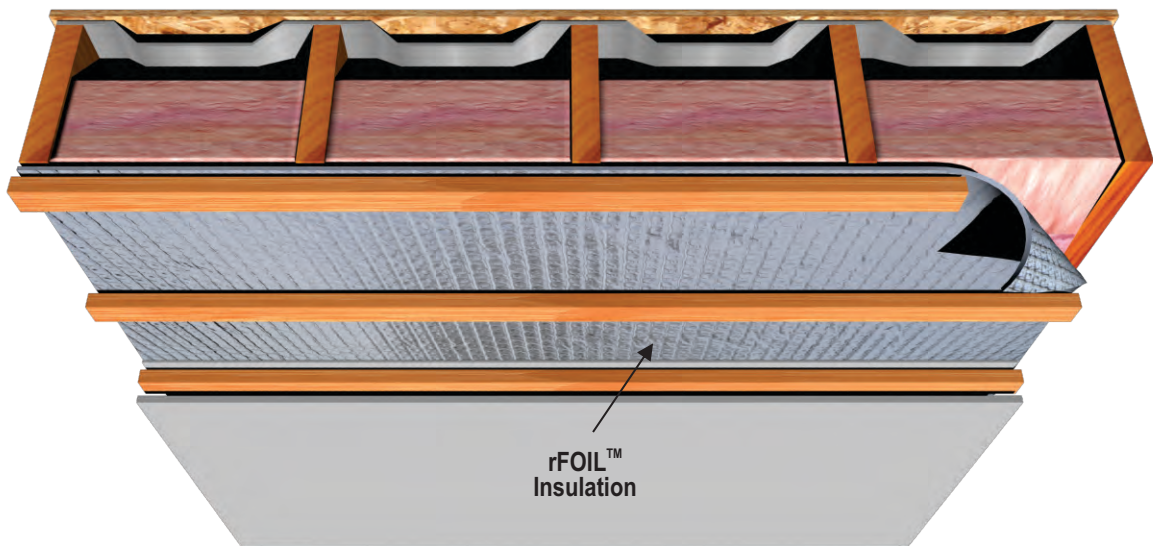

SUGGESTED PRODUCTS FOR THIS APPLICATION:

rFOIL™ INSULATION PRODUCT	2200 Series (Available in Various Dimensions)
rFOIL™ TAPE	15013 or 15012 (Reflective)

- a) Check local building codes for compliance before installation. This installation sheet is intended solely to illustrate the proper location and placement of rFOIL™ Reflective Insulation products in specific constructions applications. They are not intended to illustrate proper construction methods (which is ultimately the responsibility of the builder or contractor). The installation instructions are only recommendations relating to the location and placement of rFOIL™ Reflective Insulation products and rFOIL™ makes no claims that these construction systems are universally accurate.
- b) All warranties are void if rFOIL™ Reflective Insulation products are used in exterior applications, or in non-enclosed systems or buildings.
- c) Exercise caution when using rFOIL™ Reflective Insulation products near and around electrical wiring and devices.

